



## Evolve2™ FF

Dual Fixed + Fixed  
Monitor Arm



### Model Number

- EVOLVE2-FF-SLV
- EVOLVE2-FF-BLK
- EVOLVE2-FF-WHT

### Evolve Monitor Arm Key

- F - Fixed Monitor Arm
- M - Motion Monitor Arm
- S - Slider Mount

### Evolve For Every Need

- As workstation needs change, so can the Evolve configurations. Additional components sold separately.

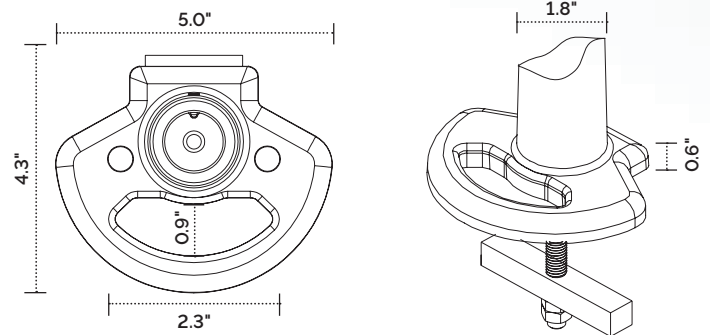

### Product Specs

- Manual height adjustment
- Recommended for worksurfaces 36.0" deep or less
- 23.10" arm extension
- 3.40" arm retraction
- +90°/-25° monitor tilt
- ±90° VESA rotation
- Up to 20.0 lb. weight capacity (per arm)
- 19.70" pole height (includes base)
- VESA 75mm/100mm quick release
- 180° lock-out feature
- Desk clamp and grommet mount included
- 48.98" max. monitor width  
*Bezel measured left to right*  
*Max. width is contingent on weight capacity*
- Meets or exceeds BIFMA x5.5 guidelines

